

# 6 Roll Tap Series

Overall length	Thread length	Thread + Neck length	Shank length	Shank dia.	Size of square	Length of square
L	ℓ	ℓn	ℓs	Ds	K	ℓk

Overall length	Thread length	Thread + Neck length	Shank length	Shank dia.	Size of square	Length of square
L	ℓ	ℓn	ℓs	Ds	K	ℓk

JIS

① Spiral Fluted Taps (for blind hole)

② Spiral Fluted Taps (for through hole)

③ Spiral Pointed Taps (for through hole)

④ Hand Taps

⑤ Cemented Carbide Taps

⑥ Roll Taps

⑦ Special Thread Taps (Single Inspection Tools)

⑧ Pipe Taps

⑨ Thread Mills

⑩ Dies

⑪ Center Drills Centering Tools

# JIS

## N+RZ/N-RZ

### Thread Forming Taps for Steels



#### Specification



■N+RZ/N-RZ are the forming taps suitable for ferrous materials such as carbon steels, alloy steels, and normal steels.

#### Recommended Tapping Speeds depending on Materials

Low carbon steels 低炭素鋼	Medium carbon steels 中炭素鋼
5~15 (m/min)	5~15 (m/min)

・Product symbol is distinguished depend on the size.

N+RZ	~M6 (coarse thread)
N-RZ	~M6 (fine threads), M7~, all U, all STI

For icon explanation, refer to icon-1

TYPE: 1

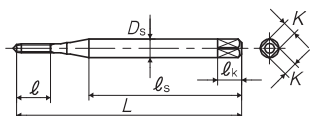

TYPE: 2

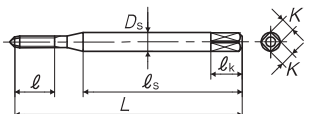

TYPE: 3

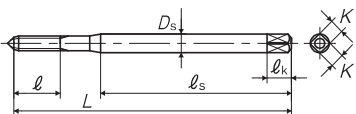

TYPE: 4

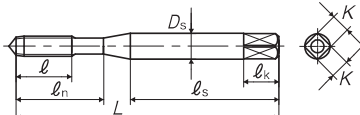

TYPE: 5

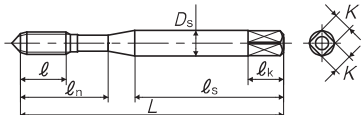

TYPE: 6

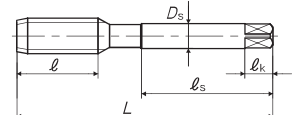

TYPE: 7

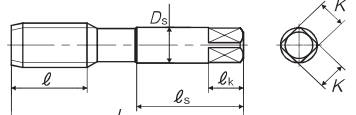

Number of oil grooves : Metric thread : M2.6 and smaller=non, M3~M7=4, M8=3, M10 and larger=4

Recommended class

Segment : 1J

Size	Class	Code	Chamfer	L (mm)	ℓ (mm)	ℓn (mm)	ℓs (mm)	Ds (mm)	K (mm)	ℓk (mm)	Lobe	TYPE	MSRP
For Metric Threads													
M1 × 0.25	G4	NRZP41.0BP	4P	36	4.5	-	24	3	2.5	5	4	1	¥ 3,380
M1 × 0.25	G4	NRZP41.0BB	2P	36	4.5	-	24	3	2.5	5	4	1	¥ 3,380
M1 × 0.25	G5	NRZP51.0BP	4P	36	4.5	-	24	3	2.5	5	4	1	¥ 3,380*
M1 × 0.25	G5	NRZP51.0BB	2P	36	4.5	-	24	3	2.5	5	4	1	¥ 3,380*
M1.2 × 0.25	G4	NRZP41.2BP	4P	36	4.5	-	24	3	2.5	5	4	1	¥ 3,380
M1.2 × 0.25	G4	NRZP41.2BB	2P	36	4.5	-	24	3	2.5	5	4	1	¥ 3,380
M1.2 × 0.25	G5	NRZP51.2BP	4P	36	4.5	-	24	3	2.5	5	4	1	¥ 3,380*
M1.2 × 0.25	G5	NRZP51.2BB	2P	36	4.5	-	24	3	2.5	5	4	1	¥ 3,380*
M1.4 × 0.3	G4	NRZP41.4CP	4P	36	5.4	-	24	3	2.5	5	4	1	¥ 2,760
M1.4 × 0.3	G4	NRZP41.4CB	2P	36	5.4	-	24	3	2.5	5	4	1	¥ 2,760
M1.4 × 0.3	G5	NRZP51.4CP	4P	36	5.4	-	24	3	2.5	5	4	1	¥ 2,760
M1.4 × 0.3	G5	NRZP51.4CB	2P	36	5.4	-	24	3	2.5	5	4	1	¥ 2,760
M1.6 × 0.35	G4	NRZP41.6DP	4P	36	6.3	-	24	3	2.5	5	4	2	¥ 2,640
M1.6 × 0.35	G4	NRZP41.6DB	2P	36	6.3	-	24	3	2.5	5	4	2	¥ 2,640
M1.6 × 0.35	G5	NRZP51.6DP	4P	36	6.3	-	24	3	2.5	5	4	2	¥ 2,640
M1.6 × 0.35	G5	NRZP51.6DB	2P	36	6.3	-	24	3	2.5	5	4	2	¥ 2,640
M1.7 × 0.35	G4	NRZP41.7DP	4P	36	6.3	-	24	3	2.5	5	4	2	¥ 2,640
M1.7 × 0.35	G4	NRZP41.7DB	2P	36	6.3	-	24	3	2.5	5	4	2	¥ 2,640
M1.7 × 0.35	G5	NRZP51.7DP	4P	36	6.3	-	24	3	2.5	5	4	2	¥ 2,640
M1.7 × 0.35	G5	NRZP51.7DB	2P	36	6.3	-	24	3	2.5	5	4	2	¥ 2,640
M1.7 × 0.35	G6	NRZP61.7DP	4P	36	6.3	-	24	3	2.5	5	4	2	¥ 2,640
M1.7 × 0.35	G6	NRZP61.7DB	2P	36	6.3	-	24	3	2.5	5	4	2	¥ 2,640
M1.8 × 0.35	G4	NRZP41.8DP	4P	42	6.3	-	27	3	2.5	5	4	2	¥ 2,640*
M1.8 × 0.35	G4	NRZP41.8DB	2P	42	6.3	-	27	3	2.5	5	4	2	¥ 2,640*
M1.8 × 0.35	G5	NRZP51.8DP	4P	42	6.3	-	27	3	2.5	5	4	2	¥ 2,640*
M1.8 × 0.35	G5	NRZP51.8DB	2P	42	6.3	-	27	3	2.5	5	4	2	¥ 2,640*
M2 × 0.4	G4	NRZP42.0EP	4P	42	7.2	-	27	3	2.5	5	4	3	¥ 2,140
M2 × 0.4	G4	NRZP42.0EB	2P	42	7.2	-	27	3	2.5	5	4	3	¥ 2,140
M2 × 0.4	G5	NRZP52.0EP	4P	42	7.2	-	27	3	2.5	5	4	3	¥ 2,140
M2 × 0.4	G5	NRZP52.0EB	2P	42	7.2	-	27	3	2.5	5	4	3	¥ 2,140
M2 × 0.4	G6	NRZP62.0EP	4P	42	7.2	-	27	3	2.5	5	4	3	¥ 2,140
M2 × 0.4	G6	NRZP62.0EB	2P	42	7.2	-	27	3	2.5	5	4	3	¥ 2,140
M2 × 0.25	G4	NRZM42.0BP	4P	42	4.5	-	27	3	2.5	5	4	3	¥ 3,250*
M2 × 0.25	G4	NRZM42.0BB	2P	42	4.5	-	27	3	2.5	5	4	3	¥ 3,250*
M2 × 0.25	G5	NRZM52.0BP	4P	42	4.5	-	27	3	2.5	5	4	3	¥ 3,250*
M2 × 0.25	G5	NRZM52.0BB	2P	42	4.5	-	27	3	2.5	5	4	3	¥ 3,250*
M2.2 × 0.45	G5	NRZP52.2FP	4P	42	8.1	-	27	3	2.5	5	4	3	¥ 1,920*
M2.2 × 0.45	G5	NRZP52.2FB	2P	42	8.1	-	27	3	2.5	5	4	3	¥ 1,920*
M2.3 × 0.4	G4	NRZP42.3EP	4P	42	7.2	-	27	3	2.5	5	4	3	¥ 1,920*
M2.3 × 0.4	G4	NRZP42.3EB	2P	42	7.2	-	27	3	2.5	5	4	3	¥ 1,920*
M2.3 × 0.4	G5	NRZP52.3EP	4P	42	7.2	-	27	3	2.5	5	4	3	¥ 1,920*
M2.3 × 0.4	G5	NRZP52.3EB	2P	42	7.2	-	27	3	2.5	5	4	3	¥ 1,920*
M2.3 × 0.4	G6	NRZP62.3EP	4P	42	7.2	-	27	3	2.5	5	4	3	¥ 1,920*
M2.3 × 0.4	G6	NRZP62.3EB	2P	42	7.2	-	27	3	2.5	5	4	3	¥ 1,920*
M2.5 × 0.45	G5	NRZP52.5FP	4P	46	8.1	14	29	3	2.5	5	4	4	¥ 1,630
M2.5 × 0.45	G5	NRZP52.5FB	2P	46	8.1	14	29	3	2.5	5	4	4	¥ 1,630

\* = Specified Distribution Items, Made to order products, For improvement, spec may change without advance notice.

Think threads with YAMAWA

JIS

⑥-5

Think threads with YAMAWA For improvement, spec may change without advance notice.

# 6

JIS

① Spiral Fluted Taps (for blind hole)

② Spiral Fluted Taps (for through hole)

③ Spiral Pointed Taps (for through hole)

④ Hand Taps

⑤ Cemented Carbide Taps

⑥ Roll Taps

⑦ Special Thread Taps (Single Inspection Tools)

⑧ Pipe Taps

⑨ Thread Mills

⑩ Dies

⑪ Center Drills Centering Tools

JIS

⑥-6

# 6 Roll Tap Series

Overall length	Thread length	Thread + Neck length	Shank length	Shank dia.	Size of square	Length of square
L	ℓ	ℓn	ℓs	Ds	K	ℓk

JIS

## N+RZ/N-RZ Thread Forming Taps for Steels

	Size	Class	Code	Chamfer	L (mm)	ℓ (mm)	ℓn (mm)	ℓs (mm)	Ds (mm)	K (mm)	ℓk (mm)	Lobe	TYPE	MSRP
① Spiral Fluted Taps (for blind hole)	M2.5 × 0.45	G6	NRZP62.5FP	4P	46	8.1	14	29	3	2.5	5	4	4	¥ 1,630
	M2.5 × 0.45	G6	NRZP62.5FB	2P	46	8.1	14	29	3	2.5	5	4	4	¥ 1,630
② Spiral Fluted Taps (for through hole)	M2.5 × 0.35	G5	NRZM52.5DP	4P	46	6.3	14	29	3	2.5	5	4	5	¥ 2,410 *
	M2.5 × 0.35	G5	NRZM52.5DB	2P	46	6.3	14	29	3	2.5	5	4	5	¥ 2,410 *
③ Spiral Pointed Taps (for through hole)	M2.6 × 0.45	G5	NRZP52.6FP	4P	46	8.1	14	29	3	2.5	5	4	4	¥ 1,630
	M2.6 × 0.45	G5	NRZP52.6FB	2P	46	8.1	14	29	3	2.5	5	4	4	¥ 1,630
④ Hand Taps	M2.6 × 0.45	G6	NRZP62.6FP	4P	46	8.1	14	29	3	2.5	5	4	4	¥ 1,630
	M2.6 × 0.45	G6	NRZP62.6FB	2P	46	8.1	14	29	3	2.5	5	4	4	¥ 1,630
⑤ Cemented Carbide Taps	M2.6 × 0.35	G5	NRZM52.6DP	4P	46	6.3	14	29	3	2.5	5	4	5	¥ 2,410 *
	M2.6 × 0.35	G5	NRZM52.6DB	2P	46	6.3	14	29	3	2.5	5	4	5	¥ 2,410 *
⑥ Roll Taps	M3 × 0.5	G5	NRZP53.0GP	4P	46	9	14	26	4	3.2	6	4	4	¥ 1,480
	M3 × 0.5	G5	NRZP53.0GB	2P	46	9	14	26	4	3.2	6	4	4	¥ 1,480
⑦ Special Thread Taps Simple inspection tools	M3 × 0.5	G6	NRZP63.0GP	4P	46	9	14	26	4	3.2	6	4	4	¥ 1,480
	M3 × 0.5	G6	NRZP63.0GB	2P	46	9	14	26	4	3.2	6	4	4	¥ 1,480
⑧ Pipe Taps	M3 × 0.5	G7	NRZP73.0GP	4P	46	9	14	26	4	3.2	6	4	4	¥ 1,480
	M3 × 0.5	G7	NRZP73.0GB	2P	46	9	14	26	4	3.2	6	4	4	¥ 1,480
⑨ Thread Mills	M3 × 0.5	G8	NRZP83.0GP	4P	46	9	14	26	4	3.2	6	4	4	¥ 1,480 *
	M3 × 0.5	G8	NRZP83.0GB	2P	46	9	14	26	4	3.2	6	4	4	¥ 1,480 *
⑩ Dies	M3 × 0.35	G5	NRZM53.0DP	4P	46	6.5	14	26	4	3.2	6	4	5	¥ 2,510 *
	M3 × 0.35	G5	NRZM53.0DB	2P	46	6.5	14	26	4	3.2	6	4	5	¥ 2,510 *
⑪ Center Drills Centering tools	M3.5 × 0.6	G5	NRZP53.5HP	4P	52	11	16	29	5	4	7	4	4	¥ 1,480
	M3.5 × 0.6	G5	NRZP53.5HB	2P	52	11	16	29	5	4	7	4	4	¥ 1,480
⑫ Center Drills Centering tools	M3.5 × 0.6	G6	NRZP63.5HP	4P	52	11	16	29	5	4	7	4	4	¥ 1,480
	M3.5 × 0.6	G6	NRZP63.5HB	2P	52	11	16	29	5	4	7	4	4	¥ 1,480
⑬ Thread Mills	M3.5 × 0.6	G7	NRZP73.5HP	4P	52	11	16	29	5	4	7	4	4	¥ 1,480 *
	M3.5 × 0.6	G7	NRZP73.5HB	2P	52	11	16	29	5	4	7	4	4	¥ 1,480 *
⑭ Dies	M4 × 0.7	G5	NRZP54.0IP	4P	52	11	17	29	5	4	7	4	4	¥ 1,480
	M4 × 0.7	G5	NRZP54.0IB	2P	52	11	17	29	5	4	7	4	4	¥ 1,480
⑮ Thread Mills	M4 × 0.7	G6	NRZP64.0IP	4P	52	11	17	29	5	4	7	4	4	¥ 1,480
	M4 × 0.7	G6	NRZP64.0IB	2P	52	11	17	29	5	4	7	4	4	¥ 1,480
⑯ Dies	M4 × 0.7	G7	NRZP74.0IP	4P	52	11	17	29	5	4	7	4	4	¥ 1,480
	M4 × 0.7	G7	NRZP74.0IB	2P	52	11	17	29	5	4	7	4	4	¥ 1,480
⑰ Thread Mills	M4 × 0.7	G8	NRZP84.0IP	4P	52	11	17	29	5	4	7	4	4	¥ 1,480 *
	M4 × 0.7	G8	NRZP84.0IB	2P	52	11	17	29	5	4	7	4	4	¥ 1,480 *
⑱ Dies	M4 × 0.5	G5	NRZM54.0GP	4P	52	9	17	29	5	4	7	4	5	¥ 2,160 *
	M4 × 0.5	G5	NRZM54.0GB	2P	52	9	17	29	5	4	7	4	5	¥ 2,160 *
⑲ Dies	M4 × 0.5	G6	NRZM64.0GP	4P	52	9	17	29	5	4	7	4	5	¥ 2,160 *
	M4 × 0.5	G6	NRZM64.0GB	2P	52	9	17	29	5	4	7	4	5	¥ 2,160 *
⑳ Dies	M4 × 0.5	G7	NRZM74.0GP	4P	52	9	17	29	5	4	7	4	5	¥ 2,160 *
	M4 × 0.5	G7	NRZM74.0GB	2P	52	9	17	29	5	4	7	4	5	¥ 2,160 *
㉑ Dies	M5 × 0.8	G5	NRZP55.0KP	4P	60	13	22	33	5.5	4.5	7	4	4	¥ 1,490 *
	M5 × 0.8	G5	NRZP55.0KB	2P	60	13	22	33	5.5	4.5	7	4	4	¥ 1,490 *
㉒ Dies	M5 × 0.8	G6	NRZP65.0KP	4P	60	13	22	33	5.5	4.5	7	4	4	¥ 1,490
	M5 × 0.8	G6	NRZP65.0KB	2P	60	13	22	33	5.5	4.5	7	4	4	¥ 1,490
㉓ Dies	M5 × 0.8	G7	NRZP75.0KP	4P	60	13	22	33	5.5	4.5	7	4	4	¥ 1,490 *
	M5 × 0.8	G7	NRZP75.0KB	2P	60	13	22	33	5.5	4.5	7	4	4	¥ 1,490 *
㉔ Dies	M5 × 0.8	G8	NRZP85.0KP	4P	60	13	22	33	5.5	4.5	7	4	4	¥ 1,490 *
	M5 × 0.8	G8	NRZP85.0KB	2P	60	13	22	33	5.5	4.5	7	4	4	¥ 1,490 *
㉕ Dies	M5 × 0.5	G6	NRZM65.0GP	4P	60	9	22	33	5.5	4.5	7	4	5	¥ 2,160 *
	M5 × 0.5	G6	NRZM65.0GB	2P	60	9	22	33	5.5	4.5	7	4	5	¥ 2,160 *

Overall length	Thread length	Thread + Neck length	Shank length	Shank dia.	Size of square	Length of square
L	ℓ	ℓn	ℓs	Ds	K	ℓk

# 6

JIS

## N+RZ/N-RZ Thread Forming Taps for Steels

	Size	Class	Code	Chamfer	L (mm)	ℓ (mm)	ℓn (mm)	ℓs (mm)	Ds (mm)	K (mm)	ℓk (mm)	Lobe	TYPE	MSRP
① Spiral Fluted Taps (for blind hole)	M6 × 1	G5	NRZP56.0MP	4P	62	15	26	33	6	4.5	7	4	4	¥ 1,620 *
	M6 × 1	G5	NRZP56.0MB	2P	62	15	26	33	6	4.5	7	4	4	¥ 1,620 *
② Spiral Fluted Taps (for through hole)	M6 × 1	G6	NRZP66.0MP	4P	62	15	26	33	6	4.5	7	4	4	¥ 1,620
	M6 × 1	G6	NRZP66.0MB	2P	62	15	26	33	6	4.5	7	4	4	¥ 1,620
③ Spiral Pointed Taps (for through hole)	M6 × 1	G7	NRZP76.0MP	4P	62	15	26	33	6	4.5	7	4	4	¥ 1,620
	M6 × 1	G7	NRZP76.0MB	2P	62	15	26	33	6	4.5	7	4	4	¥ 1,620
④ Hand Taps	M6 × 0.75	G6	NRZM66.0JP	4P	62	15	26	33	6	4.5	7	4	4	¥ 2,300 *
	M6 × 0.75	G6	NRZM66.0JB	2P	62	15	26	33	6	4.5	7	4	4	¥ 2,300 *
⑤ Cemented Carbide Taps	M6 × 0.75	G7	NRZM76.0JP	4P	62	15	26	33	6	4.5	7	4	4	¥ 2,300 *
	M6 × 0.75	G7	NRZM76.0JB	2P	62	15	26	33	6	4.5	7	4	4	¥ 2,300 *
⑥ Roll Taps	M6 × 0.5	G6	NRZM66.0GP	4P	62	9	26	33	6	4.5	7	4	5	¥ 2,300 *
	M6 × 0.5	G6	NRZM66.0GB	2P	62	9	26	33	6	4.5	7	4	5	¥ 2,300 *
⑦ Special Thread Taps Simple inspection tools	M7 × 1	G7	NRZM77.0MP	4P	70	19	-	36	6.2	5	8	4	6	¥ 2,040 *
	M7 × 1	G7	NRZM77.0MB	2P	70	19	-	36	6.2	5	8	4	6	¥ 2,040 *
⑧ Pipe Taps	M7 × 0.75	G7	NRZM77.0JP	4P	70	19	-	36	6.2	5	8	4	6	¥ 3,030 *
	M7 × 0.75	G7	NRZM77.0JB	2P	70	19	-	36	6.2	5	8	4	6	¥ 3,030 *
⑨ Thread Mills	M8 × 1.25	G7	NRZM78.0NP	4P	70	19	-	36	6.2	5	8	6	6	¥ 2,360 *
	M8 × 1.25	G7	NRZM78.0NB	2P	70	19	-	36	6.2	5	8	6	6	¥ 2,360 *
⑩ Dies	M8 × 1.25	G8	NRZM88.0NP	4P	70	19	-	36	6.2	5	8	6	6	¥ 2,360 *
	M8 × 1.25	G8	NRZM88.0NB	2P	70	19	-	36	6.2	5	8	6	6	¥ 2,360 *
⑪ Center Drills Centering tools	M8 × 1	G7	NRZM78.0MP	4P	70	19	-	36	6.2	5	8	6	6	¥ 2,690 *
	M8 × 1	G7	NRZM78.0MB	2P	70	19	-	36	6.2	5	8	6	6	¥ 2,690 *
⑫ Thread Mills	M8 × 0.75	G7	NRZM78.0JP	4P	70	19	-	36	6.2	5	8	6	6	¥ 3,030 *
	M8 × 0.75	G7	NRZM78.0JB	2P	70	19	-	36	6.2	5	8	6	6	¥ 3,030 *
⑬ Dies	M10 × 1.5	G7	NRZM70100P	4P	75	23	-	38	7	5.5	8	8	6	¥ 3,000 *
	M10 × 1.5	G7	NRZM70100B	2P	75	23	-	38	7	5.5	8	8	6	¥ 3,000 *
⑭ Thread Mills	M10 × 1.5	G8	NRZM80100P	4P	75	23	-	38	7	5.5	8	8	6	¥ 3,000 *
	M10 × 1.5	G8	NRZM80100B	2P	75	23	-	38	7	5.5	8	8	6	¥ 3,000 *
⑮ Dies	M10 × 1.25	G7	NRZM7010NP	4P	75	23	-	38	7	5.5	8	8	6	¥ 3,000 *
	M10 × 1.25	G7	NRZM7010NB	2P	75	23	-	38	7	5.5	8	8	6	¥ 3,000 *
⑯ Center Drills Centering tools	M10 × 1	G7	NRZM7010MP	4P	75	23	-	38	7	5.5	8	8	6	¥ 3,580 *
	M10 × 1	G7	NRZM7010MB	2P	75	23	-	38	7	5.5	8	8	6	¥ 3,580 *
⑰ Thread Mills	M12 × 1.75	G8	NRZM8012PP	4P	82	26	-	42	8.5	6.5	9	8	6	¥ 4,270 *</

# 6 Roll Tap Series

Overall length	Thread length	Tread + Neck length	Shank length	Shank dia.	Size of square	Length of square
L	ℓ	ℓn	ℓs	Ds	K	ℓk

JIS

## N+RZ/N-RZ Thread Forming Taps for Steels

	Size	Class	Code	Chamfer	L (mm)	ℓ (mm)	ℓn (mm)	ℓs (mm)	Ds (mm)	K (mm)	ℓk (mm)	Lobe	TYPE	MSRP
①	M14 × 2	G9	NRZM9014QP	4P	88	26	-	45	10.5	8	11	8	6	¥ 5,830*
	M14 × 2	G9	NRZM9014QB	2P	88	26	-	45	10.5	8	11	8	6	¥ 5,830*
	M14 × 2	G10	NRZM0014QP	4P	88	26	-	45	10.5	8	11	8	6	¥ 5,830*
	M14 × 2	G10	NRZM0014QB	2P	88	26	-	45	10.5	8	11	8	6	¥ 5,830*
②	M14 × 1.5	G9	NRZM90140P	4P	88	26	-	45	10.5	8	11	8	6	¥ 5,830*
	M14 × 1.5	G9	NRZM90140B	2P	88	26	-	45	10.5	8	11	8	6	¥ 5,830*
	M14 × 1	G8	NRZM8014MP	4P	88	26	-	45	10.5	8	11	8	6	¥ 6,750*
	M14 × 1	G8	NRZM8014MB	2P	88	26	-	45	10.5	8	11	8	6	¥ 6,750*
③	M16 × 2	G9	NRZM9016QP	4P	95	26	-	48	12.5	10	13	8	6	¥ 7,770*
	M16 × 2	G9	NRZM9016QB	2P	95	26	-	48	12.5	10	13	8	6	¥ 7,770*
	M16 × 2	G10	NRZM0016QP	4P	95	26	-	48	12.5	10	13	8	6	¥ 7,770*
	M16 × 2	G10	NRZM0016QB	2P	95	26	-	48	12.5	10	13	8	6	¥ 7,770*
	M16 × 1.5	G9	NRZM90160P	4P	95	26	-	48	12.5	10	13	8	6	¥ 7,770*
	M16 × 1.5	G9	NRZM90160B	2P	95	26	-	48	12.5	10	13	8	6	¥ 7,770*
	M16 × 1	G8	NRZM8016MP	4P	95	26	-	48	12.5	10	13	8	6	¥ 9,280*
	M16 × 1	G8	NRZM8016MB	2P	95	26	-	48	12.5	10	13	8	6	¥ 9,280*
	M18 × 1.5	G10	NRZM00180P	4P	100	33	-	51	14	11	14	8	6	¥ 10,400*
④	M20 × 1.5	G9	NRZM90200P	4P	105	33	-	50	15	12	15	8	7	¥ 14,300*
	M20 × 1.5	G9	NRZM90200B	2P	105	33	-	50	15	12	15	8	7	¥ 14,300*
	M20 × 1.5	G10	NRZM00200P	4P	105	33	-	50	15	12	15	8	7	¥ 14,300*
	M20 × 1.5	G10	NRZM00200B	2P	105	33	-	50	15	12	15	8	7	¥ 14,300*
⑤	For Unified Threads													
	No.4-40UNC	G5	NRZM5UN4HB	2P	46	9	14	25	4	3.2	6	4	4	¥ 1,840*
	No.6-32UNC	G6	NRZM6UN6JB	2P	52	11	17	27	5	4	7	4	4	¥ 1,710*
	5/16-18UNC	G7	NRZM7U050P	4P	70	19	-	36	6.2	5	8	6	6	¥ 2,720*
	5/16-18UNC	G7	NRZM7U050B	2P	70	19	-	36	6.2	5	8	6	6	¥ 2,720*
	3/8-24UNF	G7	NRZM7U06MP	4P	75	23	-	38	7	5.5	8	6	6	¥ 3,490*
	3/8-24UNF	G7	NRZM7U06MB	2P	75	23	-	38	7	5.5	8	6	6	¥ 3,490*
	7/16-14UNC	G8	NRZM8U07QP	4P	82	26	-	42	8.5	6.5	9	8	6	¥ 4,900*
	7/16-14UNC	G8	NRZM8U07QB	2P	82	26	-	42	8.5	6.5	9	8	6	¥ 4,900*
	7/16-20UNF	G8	NRZM8U07NP	4P	82	26	-	42	8.5	6.5	9	8	6	¥ 4,900*
	7/16-20UNF	G8	NRZM8U07NB	2P	82	26	-	42	8.5	6.5	9	8	6	¥ 4,900*
	1/2-13UNC	G8	NRZM8U08RP	4P	88	26	-	45	10.5	8	11	8	6	¥ 5,200*
	1/2-13UNC	G8	NRZM8U08RB	2P	88	26	-	45	10.5	8	11	8	6	¥ 5,200*
	1/2-20UNF	G8	NRZM8U08NP	4P	88	26	-	45	10.5	8	11	8	6	¥ 5,200*
	1/2-20UNF	G8	NRZM8U08NB	2P	88	26	-	45	10.5	8	11	8	6	¥ 5,200*

JIS

⑥-9



Think threads with YAMAWA  
 ※ = Specified Distribution Items, Made to order products.  
 For improvement, spec may change without advance notice.

# 6 Roll Tap Series

Overall length	Thread length	Tread + Neck length	Shank length	Shank dia.	Size of square	Length of square
L	ℓ	ℓn	ℓs	Ds	K	ℓk

JIS

## N+RS/N-RS Thread Forming Taps for Non-Ferrous Materials



JIS

# S

### Specification



■ N+RS/N-RS are the forming taps suitable for non-ferrous materials such as aluminum castings, aluminum diecasting and brass.

### Recommended Tapping Speeds depending on Materials

Wrought aluminum アルミ圧延材 5~15 (m/min)	Aluminum alloy casting アルミ合金鋳物 5~15 (m/min)	Zinc alloy casting 亜鉛合金鋳物 5~15 (m/min)
--	---	--

Product symbol is distinguished depend on the size.

N+RS	~M6 (coarse thread)
N-RS	~M6 (fine threads), M7~, all U, all STI

For icon explanation, refer to icon-1

JIS

⑥-11

JIS

⑥-11

JIS

⑥-11

JIS

⑥-11

JIS

⑥-11

JIS

⑥-11

JIS

⑥-11

JIS

⑥-11

JIS

⑥-11

JIS

⑥-11

JIS

⑥-11

JIS

⑥-11

JIS

⑥-11

JIS

⑥-11

JIS

⑥-11

JIS

⑥-11

JIS

⑥-11

JIS

⑥-11

JIS

⑥-11

JIS

⑥-11

JIS

⑥-11

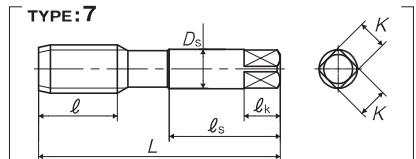
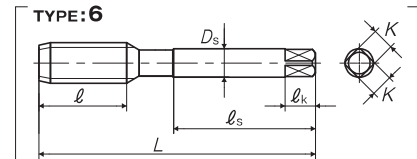
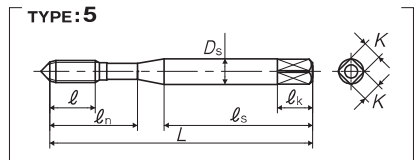
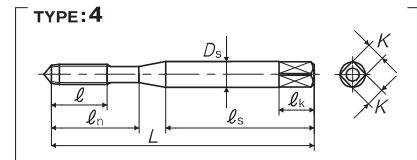
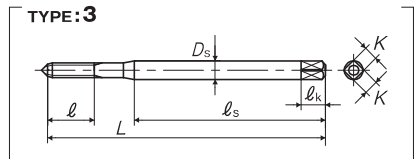
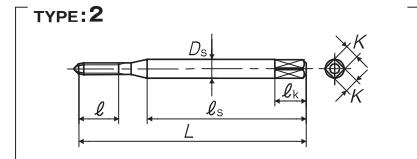

Number of oil grooves :  
 Metric thread : M2.6 and smaller=non, M3 and larger=1  
 Unified thread : No.4 and smaller=non, No.5 and larger=1

JIS

⑥-11



Think threads with YAMAWA  
 For improvement, spec may change without advance notice.

Overall length	Thread length	Tread + Neck length	Shank length	Shank dia.	Size of square	Length of square
L	ℓ	ℓn	ℓs	Ds	K	ℓk

6

JIS

Recommended class

Segment: 1J

Size	Class	Code	Chamfer	L (mm)	ℓ (mm)	ℓn (mm)	ℓs (mm)	Ds (mm)	K (mm)	ℓk (mm)	Lobe	TYPE	MSRP
For Metric Threads													
M1 × 0.25	G4	NRSP41.0BP	4P	36	4.5	-	24	3	2.5	5	4	1	¥ 3,380
M1 × 0.25	G4	NRSP41.0BB	2P	36	4.5	-	24	3	2.5	5	4	1	¥ 3,380
M1 × 0.25	G5	NRSP51.0BP	4P	36	4.5	-	24	3	2.5	5	4	1	¥ 3,380*
M1 × 0.25	G5	NRSP51.0BB	2P	36	4.5	-	24	3	2.5	5	4	1	¥ 3,380*
M1.2 × 0.25	G4	NRSP41.2BP	4P	36	4.5	-	24	3	2.5	5	4	1	¥ 3,380
M1.2 × 0.25	G4	NRSP41.2BB	2P	36	4.5	-	24	3	2.5	5	4	1	¥ 3,380
M1.2 × 0.25	G5	NRSP51.2BP	4P	36	4.5	-	24	3	2.5	5	4	1	¥ 3,380
M1.2 × 0.25	G5	NRSP51.2BB	2P	36	4.5	-	24	3	2.5	5	4	1	¥ 3,380
M1.4 × 0.3	G4	NRSP41.4CP	4P	36	5.4	-	24	3	2.5	5	4	1	¥ 2,760
M1.4 × 0.3	G4	NRSP41.4CB	2P	36	5.4	-	24	3	2.5	5	4	1	¥ 2,760
M1.4 × 0.3	G5	NRSP51.4CP	4P	36	5.4	-	24	3	2.5	5	4	1	¥ 2,760
M1.4 × 0.3	G5	NRSP51.4CB	2P	36	5.4	-	24	3	2.5	5	4	1	¥ 2,760
M1.6 × 0.35	G4	NRSP41.6DP	4P	36	6.3	-	24	3	2.5	5	4	2	¥ 2,640
M1.6 × 0.35	G4	NRSP41.6DB	2P	36	6.3	-	24	3	2.5	5	4	2	¥ 2,640
M1.6 × 0.35	G5	NRSP51.6DP	4P	36	6.3	-	24	3	2.5	5	4	2	¥ 2,640
M1.6 × 0.35	G5	NRSP51.6DB	2P	36	6.3	-	24	3	2.5	5	4	2	¥ 2,640
M1.7 × 0.35	G4	NRSP41.7DP	4P	36	6.3	-	24	3	2.5	5	4	2	¥ 2,640
M1.7 × 0.35	G4	NRSP41.7DB	2P	36	6.3	-	24	3	2.5	5	4	2	¥ 2,640
M1.7 × 0.35	G5	NRSP51.7DP	4P	36	6.3	-	24	3	2.5	5	4	2	¥ 2,640
M1.7 × 0.35	G5	NRSP51.7DB	2P	36	6.3	-	24	3	2.5	5	4	2	¥ 2,640
M1.7 × 0.35	G6	NRSP61.7DP	4P	36	6.3	-	24	3	2.5	5	4	2	¥ 2,640
M1.7 × 0.35	G6	NRSP61.7DB	2P	36	6.3	-	24	3	2.5	5	4	2	¥ 2,640
M1.8 × 0.35	G4	NRSP41.8DP	4P	42	6.3	-	27	3	2.5	5	4	2	¥ 2,640*
M1.8 × 0.35	G4	NRSP41.8DB	2P	42	6.3	-	27	3	2.5	5	4	2	¥ 2,640*
M1.8 × 0.35	G5	NRSP51.8DP	4P	42	6.3	-	27	3	2.5	5	4	2	¥ 2,640*
M1.8 × 0.35	G5	NRSP51.8DB	2P	42	6.3	-	27	3	2.5	5	4	2	¥ 2,640*
M2 × 0.4	G4	NRSP42.0EP	4P	42	7.2	-	27	3	2.5	5	4	3	¥ 2,140
M2 × 0.4	G4	NRSP42.0EB	2P	42	7.2	-	27	3	2.5	5	4	3	¥ 2,140
M2 × 0.4	G5	NRSP52.0EP	4P	42	7.2	-	27	3	2.5	5	4	3	¥ 2,140
M2 × 0.4	G5	NRSP52.0EB	2P	42	7.2	-	27	3	2.5	5	4	3	¥ 2,140
M2 × 0.4	G6	NRSP62.0EP	4P	42	7.2	-	27	3	2.5	5	4	3	¥ 2,140
M2 × 0.4	G6	NRSP62.0EB	2P	42	7.2	-	27	3	2.5	5	4	3	¥ 2,140
M2 × 0.25	G4	NRSMA2.0BP	4P	42	4.5	-	27	3	2.5	5	4	3	¥ 3,250*
M2 × 0.25	G4	NRSMA2.0BB	2P	42	4.5	-	27	3	2.5	5	4	3	¥ 3,250*
M2 × 0.25	G5	NRSM52.0BP	4P	42	4.5	-	27	3	2.5	5	4	3	¥ 3,250*
M2 × 0.25	G5	NRSM52.0BB	2P	42	4.5	-	27	3	2.5	5	4	3	¥ 3,250*
M2.3 × 0.4	G4	NRSP42.3EP	4P	42	7.2	-	27	3	2.5	5	4	3	¥ 1,920
M2.3 × 0.4	G4	NRSP42.3EB	2P	42	7.2	-	27	3	2.5	5	4	3	¥ 1,920
M2.3 × 0.4	G5	NRSP52.3EP	4P	42	7.2	-	27	3	2.5	5	4	3	¥ 1,920
M2.3 × 0.4	G5	NRSP52.3EB	2P	42	7.2	-	27	3	2.5	5	4	3	¥ 1,920
M2.3 × 0.4	G6	NRSP62.3EP	4P	42	7.2	-	27	3	2.5	5	4	3	¥ 1,920*
M2.3 × 0.4	G6	NRSP62.3EB	2P	42	7.2	-	27	3	2.5	5	4	3	¥ 1,920*
M2.5 × 0.45	G5	NRSP52.5FP	4P	46	8.1	14	29	3	2.5	5	4	4	¥ 1,630
M2.5 × 0.45	G5	NRSP52.5FB	2P	46	8.1	14	29	3	2.5	5	4	4	¥ 1,630
M2.5 × 0.45	G6	NRSP62.5FP	4P	46	8.1	14	29	3	2.5	5	4	4	¥ 1,630
M2.5 × 0.45	G6	NRSP62.5FB	2P	46	8.1	14	29	3	2.5	5	4	4	¥ 1,630
M2.5 × 0.35	G4	NRSM42.5DP	4P	46	6.3	14	29	3	2.5	5	4	5	¥ 2,410*
M2.5 × 0.35	G4	NRSM42.5DB	2P	46	6.3	14	29	3	2.5	5	4	5	¥ 2,410*

Spiral Fluted Taps  
(for blind hole)Spiral Fluted Taps  
(for through hole)Spiral Pointed Taps  
(for through hole)

Hand Taps

Cemented Carbide Taps

Roll Taps

Special Thread Taps  
Single Inspection Tools

Pipe Taps

Thread Mills

Dies

Center Drills  
Centering Tools

JIS

6-18

\* = Specified Distribution Items, Made to order products.  
For improvement, spec may change without advance notice.Think threads with  
YAMAWA

6 Roll Tap Series

JIS

N+RS/N-RS Thread Forming Taps for Non-Ferrous Materials

Overall length	Thread length	Tread + Neck length	Shank length	Shank dia.	Size of square	Length of square
L	ℓ	ℓn	ℓs	Ds	K	ℓk

Size	Class	Code	Chamfer	L (mm)	ℓ (mm)	ℓn (mm)	ℓs (mm)	Ds (mm)	K (mm)	ℓk (mm)	Lobe	TYPE	MSRP
M2.5 × 0.35	G5	NRSM52.5DP	4P	46	6.3	14	29	3	2.5	5	4	5	¥ 2,410*
M2.5 × 0.35	G5	NRSM52.5DB	2P	46	6.3	14	29	3	2.5	5	4	5	¥ 2,410*
M2.6 × 0.45	G5	NRSP52.6FP	4P	46	8.1	14	29	3	2.5	5	4	4	¥ 1,630
M2.6 × 0.45	G5	NRSP52.6FB	2P	46	8.1	14	29	3	2.5	5	4	4	¥ 1,630
M2.6 × 0.45	G6	NRSP62.6FP	4P	46	8.1	14	29	3	2.5	5	4	4	¥ 1,630
M2.6 × 0.45	G6	NRSP62.6FB	2P	46	8.1	14	29	3	2.5	5	4	4	¥ 1,630
M2.6 × 0.35	G5	NRSM52.6DP	4P	46	6.3	14	29	3	2.5	5	4	5	¥ 2,410*
M2.6 × 0.35	G5	NRSM52.6DB	2P	46	6.3	14	29	3	2.5	5	4	5	¥ 2,410*
M2.6 × 0.35	G6	NRSM62.6DP	4P	46	6.3	14	29	3	2.5	5	4	5	¥ 2,410*
M2.6 × 0.35	G6	NRSM62.6DB	2P	46	6.3	14	29	3	2.5	5	4	5	¥ 2,410*
M3 × 0.5	G5	NRSP53.0GP	4P	46	9	14	26	4	3.2	6	4	4	¥ 1,480
M3 × 0.5	G5	NRSP53.0GB	2P	46	9	14	26	4	3.2	6	4	4	¥ 1,480
M3 × 0.5	G6	NRSP63.0GP	4P	46	9	14	26	4	3.2	6	4	4	¥ 1,480
M3 × 0.5	G6	NRSP63.0GB	2P	46	9	14	26	4	3.2	6	4	4	¥ 1,480
M3 × 0.5	G7	NRSP73.0GP	4P	46	9	14	26	4	3.2	6	4	4	¥ 1,480
M3 × 0.5	G7	NRSP73.0GB	2P	46	9	14	26	4	3.2	6	4	4	¥ 1,480
M3 × 0.5	G8	NRSP83.0GP	4P	46	9	14	26	4	3.2	6	4	4	¥ 1,480*
M3 × 0.5	G8	NRSP83.0GB	2P	46	9	14	26	4	3.2	6	4	4	¥ 1,480*
M3 × 0.35	G5	NRSM53.0DP	4P	46	6.5	14	26	4	3.2	6	4	5	¥ 2,510*
M3 × 0.35	G5	NRSM53.0DB	2P	46	6.5	14	26	4	3.2	6	4	5	¥ 2,510*
M3 × 0.35	G6	NRSM63.0DP	4P	46	6.5	14	26	4	3.2	6	4	5	¥ 2,510*
M3 × 0.35	G6	NRSM63.0DB	2P	46	6.5	14	26	4	3.2	6	4	5	¥ 2,510*
M3.5 × 0.6	G5	NRSP53.5HP	4P	52	11	16	29	5	4	7	4	4	¥ 1,480
M3.5 × 0.6	G5	NRSP53.5HB	2P	52	11	16	29	5	4	7	4	4	¥ 1,480
M3.5 × 0.6	G6	NRSP63.5HP	4P	52	11	16	29	5	4	7	4	4	¥ 1,480
M3.5 × 0.6	G6	NRSP63.5HB	2P	52	11	16	29	5	4	7	4	4	¥ 1,480
M3.5 × 0.6	G7	NRSP73.5HP	4P	52	11	16	29	5	4	7	4	4	¥ 1,480*
M3.5 × 0.6	G7	NRSP73.5HB	2P	52	11	16	29	5	4	7	4	4	¥ 1,480*
M3.5 × 0.35	G5	NRSM53.5DP	4P	52	6.5	16	29	5	4	7	4	5	¥ 2,510*
M3.5 × 0.35	G5	NRSM53.5DB	2P	52	6.5	16	29	5	4	7	4	5	¥ 2,510*
M3.5 × 0.35	G6	NRSM63.5DP	4P	52	6.5	16	29	5	4	7	4	5	¥ 2,510*
M3.5 × 0.35	G6	NRSM63.5DB	2P	52	6.5	16	29	5	4	7	4	5	¥ 2,510*
M4 × 0.7	G5	NRSP54.0IP	4P	52	11	17	29	5	4	7	4	4	¥ 1,480
M4 × 0.7	G5	NRSP54.0IB	2P	52	11	17	29	5	4	7	4	4	¥ 1,480
M4 × 0.7	G6	NRSP64.0IP	4P	52	11	17	29	5	4	7	4	4	¥ 1,480
M4 × 0.7	G6	NRSP64.0IB	2P	52	1								



Overall length	Thread length	Thread + Neck length	Shank length	Shank dia.	Size of square	Length of square
L	ℓ	ℓn	ℓs	Ds	K	ℓk

### N+RS/N-RS Thread Forming Taps for Non-Ferrous Materials

Size	Class	Code	Chamfer	L (mm)	ℓ (mm)	ℓn (mm)	ℓs (mm)	Ds (mm)	K (mm)	ℓk (mm)	Lobe	TYPE	MSRP
M5 × 0.5	G6	NRSM65.0GP	4P	60	9	22	33	5.5	4.5	7	4	5	¥ 2,160*
M5 × 0.5	G6	NRSM65.0GB	2P	60	9	22	33	5.5	4.5	7	4	5	¥ 2,160*
M5 × 0.5	G7	NRSM75.0GP	4P	60	9	22	33	5.5	4.5	7	4	5	¥ 2,160*
M5 × 0.5	G7	NRSM75.0GB	2P	60	9	22	33	5.5	4.5	7	4	5	¥ 2,160*
M6 × 1	G5	NRSP56.0MP	4P	62	15	26	33	6	4.5	7	4	4	¥ 1,620*
M6 × 1	G5	NRSP56.0MB	2P	62	15	26	33	6	4.5	7	4	4	¥ 1,620*
M6 × 1	G6	NRSP66.0MP	4P	62	15	26	33	6	4.5	7	4	4	¥ 1,620*
M6 × 1	G6	NRSP66.0MB	2P	62	15	26	33	6	4.5	7	4	4	¥ 1,620*
M6 × 1	G7	NRSP76.0MP	4P	62	15	26	33	6	4.5	7	4	4	¥ 1,620*
M6 × 1	G7	NRSP76.0MB	2P	62	15	26	33	6	4.5	7	4	4	¥ 1,620*
M6 × 1	G8	NRSP86.0MP	4P	62	15	26	33	6	4.5	7	4	4	¥ 1,620*
M6 × 1	G8	NRSP86.0MB	2P	62	15	26	33	6	4.5	7	4	4	¥ 1,620*
M6 × 0.75	G6	NRSM66.0JP	4P	62	15	26	33	6	4.5	7	4	4	¥ 2,300*
M6 × 0.75	G6	NRSM66.0JB	2P	62	15	26	33	6	4.5	7	4	4	¥ 2,300*
M6 × 0.75	G7	NRSM76.0JP	4P	62	15	26	33	6	4.5	7	4	4	¥ 2,300*
M6 × 0.75	G7	NRSM76.0JB	2P	62	15	26	33	6	4.5	7	4	4	¥ 2,300*
M6 × 0.5	G6	NRSM66.0GP	4P	62	9	26	33	6	4.5	7	4	5	¥ 2,300*
M6 × 0.5	G6	NRSM66.0GB	2P	62	9	26	33	6	4.5	7	4	5	¥ 2,300*
M7 × 1	G6	NRSM67.0MP	4P	70	19	-	36	6.2	5	8	4	6	¥ 2,040*
M7 × 1	G6	NRSM67.0MB	2P	70	19	-	36	6.2	5	8	4	6	¥ 2,040*
M7 × 1	G7	NRSM77.0MP	4P	70	19	-	36	6.2	5	8	4	6	¥ 2,040*
M7 × 1	G7	NRSM77.0MB	2P	70	19	-	36	6.2	5	8	4	6	¥ 2,040*
M7 × 0.75	G7	NRSM77.0JP	4P	70	19	-	36	6.2	5	8	4	6	¥ 3,030*
M7 × 0.75	G7	NRSM77.0JB	2P	70	19	-	36	6.2	5	8	4	6	¥ 3,030*
M8 × 1.25	G7	NRSM78.0NP	4P	70	19	-	36	6.2	5	8	6	6	¥ 2,360
M8 × 1.25	G7	NRSM78.0NB	2P	70	19	-	36	6.2	5	8	6	6	¥ 2,360
M8 × 1.25	G8	NRSM88.0NP	4P	70	19	-	36	6.2	5	8	6	6	¥ 2,360
M8 × 1.25	G8	NRSM88.0NB	2P	70	19	-	36	6.2	5	8	6	6	¥ 2,360
M8 × 1	G7	NRSM78.0MP	4P	70	19	-	36	6.2	5	8	6	6	¥ 2,690*
M8 × 1	G7	NRSM78.0MB	2P	70	19	-	36	6.2	5	8	6	6	¥ 2,690*
M8 × 0.75	G7	NRSM78.0JP	4P	70	19	-	36	6.2	5	8	6	6	¥ 3,030*
M8 × 0.75	G7	NRSM78.0JB	2P	70	19	-	36	6.2	5	8	6	6	¥ 3,030*
M10 × 1.5	G7	NRSM70100P	4P	75	23	-	38	7	5.5	8	6	6	¥ 3,000
M10 × 1.5	G7	NRSM70100B	2P	75	23	-	38	7	5.5	8	6	6	¥ 3,000
M10 × 1.5	G8	NRSM80100P	4P	75	23	-	38	7	5.5	8	6	6	¥ 3,000*
M10 × 1.5	G8	NRSM80100B	2P	75	23	-	38	7	5.5	8	6	6	¥ 3,000*
M10 × 1.25	G7	NRSM7010NP	4P	75	23	-	38	7	5.5	8	6	6	¥ 3,000*
M10 × 1.25	G7	NRSM7010NB	2P	75	23	-	38	7	5.5	8	6	6	¥ 3,000*
M10 × 1.25	G8	NRSM8010NP	4P	75	23	-	38	7	5.5	8	6	6	¥ 3,000*
M10 × 1.25	G8	NRSM8010NB	2P	75	23	-	38	7	5.5	8	6	6	¥ 3,000*
M10 × 1	G7	NRSM7010MP	4P	75	23	-	38	7	5.5	8	6	6	¥ 3,580*
M10 × 1	G7	NRSM7010MB	2P	75	23	-	38	7	5.5	8	6	6	¥ 3,580*
M12 × 1.75	G8	NRSM8012PP	4P	82	26	-	42	8.5	6.5	9	6	6	¥ 4,270*
M12 × 1.75	G8	NRSM8012PB	2P	82	26	-	42	8.5	6.5	9	6	6	¥ 4,270*
M12 × 1.75	G9	NRSM9012PP	4P	82	26	-	42	8.5	6.5	9	6	6	¥ 4,270*
M12 × 1.75	G9	NRSM9012PB	2P	82	26	-	42	8.5	6.5	9	6	6	¥ 4,270*
M12 × 1.5	G8	NRSM80120P	4P	82	26	-	42	8.5	6.5	9	6	6	¥ 4,270*
M12 × 1.5	G8	NRSM80120B	2P	82	26	-	42	8.5	6.5	9	6	6	¥ 4,270*
M12 × 1.5	G9	NRSM90120P	4P	82	26	-	42	8.5	6.5	9	6	6	¥ 4,270*
M12 × 1.5	G9	NRSM90120B	2P	82	26	-	42	8.5	6.5	9	6	6	¥ 4,270*

## 6 JIS

- ① Spiral Fluted Taps (for blind hole)
- ② Spiral Fluted Taps (for through hole)
- ③ Spiral Pointed Taps (for through hole)
- ④ Hand Taps
- ⑤ Cemented Carbide Taps
- ⑥ Roll Taps
- ⑦ Special Thread Taps (Single Inspection Tools)
- ⑧ Pipe Taps
- ⑨ Thread Mills
- ⑩ Dies
- ⑪ Center Drills (Centering Tools)

\* = Specified Distribution Items, Made to order products. For improvement, spec may change without advance notice.



## 6 JIS Roll Tap Series

Overall length	Thread length	Thread + Neck length	Shank length	Shank dia.	Size of square	Length of square
L	ℓ	ℓn	ℓs	Ds	K	ℓk

### N+RS/N-RS Thread Forming Taps for Non-Ferrous Materials

Size	Class	Code	Chamfer	L (mm)	ℓ (mm)	ℓn (mm)	ℓs (mm)	Ds (mm)	K (mm)	ℓk (mm)	Lobe	TYPE	MSRP
M12 × 1.25	G8	NRSM8012NP	4P	82	26	-	42	8.5	6.5	9	6	6	¥ 4,270*
M12 × 1.25	G8	NRSM8012NB	2P	82	26	-	42	8.5	6.5	9	6	6	¥ 4,270*
M12 × 1.25	G9	NRSM9012NP	4P	82	26	-	42	8.5	6.5	9	6	6	¥ 4,270*
M12 × 1.25	G9	NRSM9012NB	2P	82	26	-	42	8.5	6.5	9	6	6	¥ 4,270*
M12 × 1	G7	NRSM7012MP	4P	82	26	-	42	8.5	6.5	9	6	6	¥ 5,000*
M12 × 1	G7	NRSM7012MB	2P	82	26	-	42	8.5	6.5	9	6	6	¥ 5,000*
M14 × 2	G9	NRSM90140P	4P	88	26	-	45	10.5	8	11	6	6	¥ 5,830*
M14 × 2	G9	NRSM90140B	2P	88	26	-	45	10.5	8	11	6	6	¥ 5,830*
M14 × 2	G10	NRSM00140P	4P	88	26	-	45	10.5	8	11	6	6	¥ 5,830*
M14 × 2	G10	NRSM00140B	2P	88	26	-	45	10.5	8	11	6	6	¥ 5,830*
M14 × 1.5	G9	NRSM90140P	4P	88	26	-	45	10.5	8	11	6	6	¥ 5,830*
M14 × 1.5	G9	NRSM90140B	2P	88	26	-	45	10.5	8	11	6	6	¥ 5,830*
M14 × 1	G8	NRSM8014MP	4P	88	26	-	45	10.5	8	11	6	6	¥ 6,750*
M14 × 1	G8	NRSM8014MB	2P	88	26	-	45	10.5	8	11	6	6	¥ 6,750*
M16 × 2	G9	NRSM90160P	4P	95	26	-	48	12.5	10	13	6	6	¥ 7,770*
M16 × 2	G9	NRSM90160B	2P	95	26	-	48	12.5	10	13	6	6	¥ 7,770*
M16 × 2	G10	NRSM00160P	4P	95	26	-	48	12.5	10	13	6	6	¥ 7,770*
M16 × 2	G10	NRSM00160B	2P	95	26	-	48	12.5	10	13	6	6	¥ 7,770*
M16 × 1.5	G9	NRSM90160P	4P	95	26	-	48	12.5	10	13	6	6	¥ 7,770*
M16 × 1.5	G9	NRSM90160B	2P	95	26	-	48	12.5	10	13	6	6	¥ 7,770*
M16 × 1	G8	NRSM8016MP	4P	95	26	-	48	12.5	10	13	6	6	¥ 9,280*
M16 × 1	G8	NRSM8016MB	2P	95	26	-	48	12.5	10	13	6	6	¥ 9,280*
M18 × 1.5	G9	NRSM90180P	4P	100	33	-	51	14	11	14	6	6	¥ 10,400*
M18 × 1.5	G9	NRSM90180B	2P	100	33	-	51	14	11	14	6	6	¥ 10,400*
M20 × 2.5	G11	NRSM1020RP	4P	105	33	-	50	15	12	15	6	7	¥ 14,300*
M20 × 2.5	G11	NRSM1020RB	2P	105	33	-	50	15	12	15	6	7	¥ 14,300*
M20 × 1.5	G9	NRSM90200P	4P	105	33	-	50	15	12	15	6	7	¥ 14,300*
M20 × 1.5	G9	NRSM90200B	2P	105	33	-	50	15	12	15	6	7	¥ 14,300*
M20 × 1.5	G10	NRSM00200P	4P	105	33	-	50	15	12	15	6	7	¥ 14,300*
M20 × 1.5	G10	NRSM00200B	2P	105	33	-	50	15	12	15	6	7	¥ 14,300*
For Unified Threads													
No.0-80UNF	G5	NRSM5UN0BP	4P	36	6.3	-	24	3	2.5	5	3	2	¥ 3,020*
No.0-80UNF	G5	NRSM5UN0BB	2P	36	6.3	-	24	3	2.5	5	3	2	¥ 3,020*
No.1-72UNF	G5	NRSM5UN1CP	4P	42	7.2	-	27	3	2.5	5	3	2	¥ 3,020*
No.1-72UNF	G5	NRSM5UN1CB	2P	42	7.2	-	27	3	2.5	5	3	2	¥ 3,020*
No.2-56UNC	G4	NRSM4UN2EP	4P	42	8.1	-	27	3	2.5	5	4	3	¥ 2,210*
No.2-56UNC	G4	NRSM4UN2EB	2P	42	8.1	-	27	3	2.5	5	4	3	¥ 2,210*
No.2-56UNC	G5	NRSM5UN2EP	4P	42	8.1	-	27	3	2.5	5	4	3	¥ 2,210*
No.2-56UNC	G5	NRSM5UN2EB	2P	42	8.1	-	27	3	2.5	5	4	3	¥ 2,210*
No.2-56UNC	G6	NRSM6UN2EP	4P	42	8.1	-	27	3	2.5	5	4	3	¥ 2,210*
No.2-56UNC	G6	NRSM6UN2EB	2P	42	8.1	-	27	3	2.5	5	4	3	¥ 2,210*
No.2-56UNC	G7	NRSM7UN2EP	4P	42	8.1	-	27	3	2.5	5	4	3	¥ 2,210*
No.2-56UNC	G7	NRSM7UN2EB	2P	42	8.1	-	27	3	2.5	5	4	3	¥ 2,210*
No.3-48UNC	G4	NRSM4UN3FP	4P	46	8.1	14	29	3	2.5	5	4	4	¥ 1,850*
No.3-48UNC	G4	NRSM4UN3FB	2P	46	8.1	14	29	3	2.5	5	4	4	¥ 1,850*
No.3-48UNC	G5	NRSM5UN3FP	4P	46	8.1	14	29	3	2.5	5	4	4	¥ 1,850*
No.3-48UNC	G5	NRSM5UN3FB	2P	46	8.1	14	29	3	2.5	5	4	4	¥ 1,850*
No.4-40UNC	G5	NRSM5UN4HP	4P	46	9	14	25	4	3.2	6	4	4	¥ 1,840*
No.4-40UNC	G5	NRSM5UN4HB	2P	46	9	14	25	4	3.2	6	4	4	¥ 1,840*
No.4-40UNC	G6	NRSM6UN4HP	4P	46									

Overall length	Thread length	Thread + Neck length	Shank length	Shank dia.	Size of square	Length of square
L	ℓ	ℓn	ℓs	Ds	K	ℓk

6

JIS

## N+RS/N-RS Thread Forming Taps for Non-Ferrous Materials

Size	Class	Code	Chamfer	L (mm)	ℓ (mm)	ℓn (mm)	ℓs (mm)	Ds (mm)	K (mm)	ℓk (mm)	Lobe	TYPE	MSRP
No.4-40UNC	G6	NRSM6UN4HB	2P	46	9	14	25	4	3.2	6	4	4	¥ 1,840*
No.4-40UNC	G7	NRSM7UN4HP	4P	46	9	14	25	4	3.2	6	4	4	¥ 1,840*
No.4-40UNC	G7	NRSM7UN4HB	2P	46	9	14	25	4	3.2	6	4	4	¥ 1,840*
No.4-48UNF	G5	NRSM5UN4FP	4P	46	9	14	25	4	3.2	6	4	4	¥ 1,840*
No.4-48UNF	G5	NRSM5UN4FB	2P	46	9	14	25	4	3.2	6	4	4	¥ 1,840*
No.4-48UNF	G6	NRSM6UN4FP	4P	46	9	14	25	4	3.2	6	4	4	¥ 1,840*
No.4-48UNF	G6	NRSM6UN4FB	2P	46	9	14	25	4	3.2	6	4	4	¥ 1,840*
No.5-40UNC	G5	NRSM5UN5HP	4P	52	11	16	28	5	4	7	4	4	¥ 1,710*
No.5-44UNF	G6	NRSM6UN5GB	2P	52	11	16	28	5	4	7	4	4	¥ 1,710*
No.6-32UNC	G5	NRSM5UN6JP	4P	52	11	17	27	5	4	7	4	4	¥ 1,710*
No.6-32UNC	G5	NRSM5UN6JB	2P	52	11	17	27	5	4	7	4	4	¥ 1,710*
No.6-32UNC	G6	NRSM6UN6JP	4P	52	11	17	27	5	4	7	4	4	¥ 1,710*
No.6-32UNC	G6	NRSM6UN6JB	2P	52	11	17	27	5	4	7	4	4	¥ 1,710*
No.6-32UNC	G7	NRSM7UN6JP	4P	52	11	17	27	5	4	7	4	4	¥ 1,710*
No.6-32UNC	G7	NRSM7UN6JB	2P	52	11	17	27	5	4	7	4	4	¥ 1,710*
No.6-40UNF	G5	NRSM5UN6HP	4P	52	11	17	27	5	4	7	4	4	¥ 1,710*
No.6-40UNF	G5	NRSM5UN6HB	2P	52	11	17	27	5	4	7	4	4	¥ 1,710*
No.8-32UNC	G6	NRSM6UN8JP	4P	60	13	22	31	5.5	4.5	7	4	4	¥ 1,720*
No.8-32UNC	G6	NRSM6UN8JB	2P	60	13	22	31	5.5	4.5	7	4	4	¥ 1,720*
No.8-32UNC	G7	NRSM7UN8JP	4P	60	13	22	31	5.5	4.5	7	4	4	¥ 1,720*
No.8-32UNC	G7	NRSM7UN8JB	2P	60	13	22	31	5.5	4.5	7	4	4	¥ 1,720*
No.8-32UNC	G8	NRSM8UN8JP	4P	60	13	22	31	5.5	4.5	7	4	4	¥ 1,720*
No.8-36UNF	G5	NRSM5UN8IP	4P	60	13	22	31	5.5	4.5	7	4	4	¥ 1,720*
No.8-36UNF	G5	NRSM5UN8IB	2P	60	13	22	31	5.5	4.5	7	4	4	¥ 1,720*
No.8-36UNF	G6	NRSM6UN8IB	2P	60	13	22	31	5.5	4.5	7	4	4	¥ 1,720*
No.10-24UNC	G6	NRSM6UNAMP	4P	60	13	22	32	5.5	4.5	7	4	4	¥ 1,720*
No.10-24UNC	G6	NRSM6UNAMB	2P	60	13	22	32	5.5	4.5	7	4	4	¥ 1,720*
No.10-24UNC	G7	NRSM7UNAMP	4P	60	13	22	32	5.5	4.5	7	4	4	¥ 1,720*
No.10-24UNC	G7	NRSM7UNAMB	2P	60	13	22	32	5.5	4.5	7	4	4	¥ 1,720*
No.10-32UNF	G6	NRSM6UNAJP	4P	60	13	22	32	5.5	4.5	7	4	4	¥ 1,720*
No.10-32UNF	G6	NRSM6UNAJB	2P	60	13	22	32	5.5	4.5	7	4	4	¥ 1,720*
No.10-32UNF	G7	NRSM7UNAJP	4P	60	13	22	32	5.5	4.5	7	4	4	¥ 1,720*
No.10-32UNF	G7	NRSM7UNAJB	2P	60	13	22	32	5.5	4.5	7	4	4	¥ 1,720*
1/4-20UNC	G6	NRSM6U04NP	4P	62	15	26	33	6	4.5	7	4	4	¥ 1,850*
1/4-20UNC	G6	NRSM6U04NB	2P	62	15	26	33	6	4.5	7	4	4	¥ 1,850*
1/4-20UNC	G7	NRSM7U04NP	4P	62	15	26	33	6	4.5	7	4	4	¥ 1,850*
1/4-20UNC	G7	NRSM7U04NB	2P	62	15	26	33	6	4.5	7	4	4	¥ 1,850*
1/4-20UNC	G8	NRSM8U04NP	4P	62	15	26	33	6	4.5	7	4	4	¥ 1,850*
1/4-20UNC	G8	NRSM8U04NB	2P	62	15	26	33	6	4.5	7	4	4	¥ 1,850*
1/4-28UNF	G6	NRSM6U04KP	4P	62	15	26	33	6	4.5	7	4	4	¥ 1,850*
1/4-28UNF	G6	NRSM6U04KB	2P	62	15	26	33	6	4.5	7	4	4	¥ 1,850*
1/4-28UNF	G7	NRSM7U04KB	2P	62	15	26	33	6	4.5	7	4	4	¥ 1,850*

Spiral Fluted Taps  
(for blind hole)

①

Spiral Fluted Taps  
(for through hole)

②

Spiral Pointed Taps  
(for through hole)

③

Hand Taps

④

Cemented  
Carbide Taps

⑤

Roll Taps

⑥

Special Thread Taps  
Single Inspection Tools

⑦

Pipe Taps

⑧

Thread Mills

⑨

Dies

⑩

Center Drills  
Centering Tools

⑪

\* = Specified Distribution Items, Made to order products.  
For improvement, spec may change without advance notice.Think threads with  
**YAMAWA**

JIS

⑥-22