

### 3 Spiral Pointed Tap Series for through hole

Overall length	Chamfer + full thread	Thread length	Thread + neck length	Shank length	Shank dia.	Size of square	Length of square
L	ℓt	ℓ	ℓn	ℓs	Ds	K	ℓk

JIS

1 Spiral Fluted Taps (for blind hole)

2 Spiral Fluted Taps (for through hole)

3 Spiral Pointed Taps (for through hole)

4 Hand Taps

5 Cemented Carbide Taps

6 Roll Taps

7 Special Thread Taps (Simple Inspection Tools)

8 Pipe Taps

9 Thread Mills

10 Dies

11 Center Drills Centering tools

JIS

3-67

# JIS

## LS-SU-S-PO

Long Shank Short Spiral Pointed Taps for Stainless Steels

### Specification



Long shank spiral pointed tap suitable for stainless steels tending to cause work harden and sticky, as well as chrome steels and molybdenum steels. Through hole use. Tapping of rather deep holes is possible.

### Recommended Tapping Speeds depending on Materials

Low carbon steels 低炭素鋼	Medium carbon steels 中炭素鋼	High carbon steels 高炭素鋼	Stainless steels ステンレス鋼
5~10 (m/min)	5~10 (m/min)	5~10 (m/min)	~5 (m/min)

For icon explanation, refer to icon-1

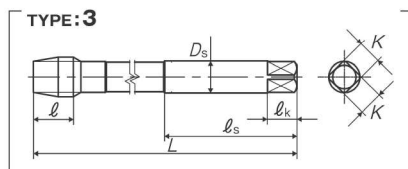
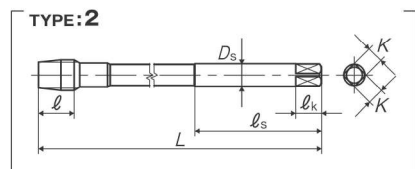
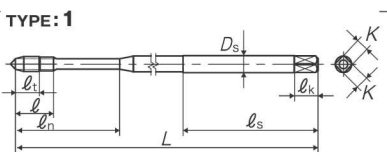

Segment : 1E

Size	Class	Code	Chamfer	L (mm)	ℓt (mm)	ℓ (mm)	ℓn (mm)	ℓs (mm)	Ds (mm)	K (mm)	ℓk (mm)	No. of flutes	TYPE	MSRP
For Metric Threads														
M3 × 0.5	P2	PY3.0QGGEXES	4.5P	100	5	9	28	40	4	3.2	6	3	1	¥ 3,810*
M4 × 0.7	P2	PY4.0IQGEXES	4.5P	100	7	11	31	40	5	4	7	3	1	¥ 3,480*
M4 × 0.7	P2	PY4.0IQGEXGS	4.5P	150	7	11	31	40	5	4	7	3	1	¥ 6,640*
M5 × 0.8	P2	PY5.0KQGEXES	4.5P	100	9	13	38	40	5.5	4.5	7	3	1	¥ 3,050*
M5 × 0.8	P2	PY5.0KQGEXGS	4.5P	150	9	13	38	40	5.5	4.5	7	3	1	¥ 5,160*
M6 × 1	P2	PY6.0MQGEXES	4.5P	100	11	15	45	40	6	4.5	7	3	1	¥ 2,600*
M6 × 1	P2	PY6.0MQGEXGS	4.5P	150	11	15	45	40	6	4.5	7	3	1	¥ 4,600*
M8 × 1.25	P3	PY8.0NRGEXES	5P	100	-	12	-	50	6.2	5	8	3	2	¥ 3,370*
M8 × 1.25	P3	PY8.0NRGEXGS	5P	150	-	12	-	50	6.2	5	8	3	2	¥ 5,750*
M10 × 1.5	P3	PY0100RGEXES	5P	100	-	13	-	50	7	5.5	8	3	2	¥ 4,100*
M10 × 1.5	P3	PY0100RGEXGS	5P	150	-	13	-	50	7	5.5	8	3	2	¥ 6,690*
M10 × 1.25	P3	PY010NRGEXGS	5P	150	-	13	-	50	7	5.5	8	3	2	¥ 6,690*
M12 × 1.75	P4	PY012PSGEXES	5P	100	-	15	-	50	8.5	6.5	9	3	2	¥ 5,020*
M12 × 1.75	P4	PY012PSGEXGS	5P	150	-	15	-	50	8.5	6.5	9	3	2	¥ 8,380*
M12 × 1.5	P3	PY0120RGEXGS	5P	150	-	15	-	50	8.5	6.5	9	3	2	¥ 8,380*
M12 × 1.25	P4	PY012NSGEXGS	5P	150	-	15	-	50	8.5	6.5	9	3	2	¥ 8,380*
M14 × 2	P4	PY014QSGEXGS	5P	150	-	18	-	60	10.5	8	11	3	2	¥ 10,500*
M14 × 1.5	P3	PY0140RGEXGS	5P	150	-	14	-	60	10.5	8	11	3	2	¥ 10,500*

Think threads with YAMAWA

\* = Specified Distribution Items. Made to order products. For improvement, spec may change without advance notice.

Overall length	Chamfer + full thread	Thread length	Thread + neck length	Shank length	Shank dia.	Size of square	Length of square
L	ℓt	ℓ	ℓn	ℓs	Ds	K	ℓk

### 3

JIS

1 Spiral Fluted Taps (for blind hole)

2 Spiral Fluted Taps (for through hole)

3 Spiral Pointed Taps (for through hole)

4 Hand Taps

5 Cemented Carbide Taps

6 Roll Taps

7 Special Thread Taps (Simple Inspection Tools)

8 Pipe Taps

9 Thread Mills

10 Dies

11 Center Drills Centering tools

JIS

3-68

Size	Class	Code	Chamfer	L (mm)	ℓt (mm)	ℓ (mm)	ℓn (mm)	ℓs (mm)	Ds (mm)	K (mm)	ℓk (mm)	No. of flutes	TYPE	MSRP
M16 × 2	P4	PY016QSGEXGS	5P	150	-	18	-	60	12.5	10	13	3	2	¥ 11,400*
M16 × 2	P4	PY016QSGEXKS	5P	200	-	18	-	60	12.5	10	13	3	2	¥ 15,000*
M16 × 1.5	P3	PY0160RGEXGS	5P	150	-	14	-	60	12.5	10	13	3	2	¥ 11,400*
M16 × 1.5	P3	PY0160RGEXKS	5P	200	-	14	-	60	12.5	10	13	3	2	¥ 15,000*
M18 × 2.5	P4	PY018RSGEXKS	5P	200	-	20	-	70	14	11	14	3	2	¥ 19,600*
M18 × 1.5	P4	PY0180SGEXKS	5P	200	-	14	-	70	14	11	14	3	2	¥ 19,600*
M20 × 2.5	P4	PY020RSGEXKS	5P	150	-	20	-	70	15	12	15	3	3	¥ 19,900*
M20 × 2.5	P4	PY020RSGEXGS	5P	200	-	20	-	70	15	12	15	3	3	¥ 24,900*
M20 × 1.5	P4	PY0200SGEXGS	5P	150	-	14	-	70	15	12	15	3	3	¥ 19,900*
M20 × 1.5	P4	PY0200SGEXKS	5P	200	-	14	-	70	15	12	15	3	3	¥ 24,900*
M22 × 2.5	P4	PY022RSGEXKS	5P	200	-	20	-	70	17	13	16	3	3	¥ 27,600*
M22 × 1.5	P4	PY0220SGEXKS	5P	200	-	14	-	70	17	13	16	3	3	¥ 27,600*
M24 × 3	P4	PY024SSGEXKS	5P	200	-	25	-	80	19	15	18	3	3	¥ 31,100*
M24 × 1.5	P4	PY0240SGEXKS	5P	200	-	18	-	80	19	15	18	3	3	¥ 31,100*

\* = Specified Distribution Items. Made to order products. For improvement, spec may change without advance notice.

Think threads with YAMAWA

JIS

3-68