

3 Spiral Pointed Tap Series for through hole

Overall length	Thread length	Thread + Neck length	Shank length	Shank dia.	Size of square	Length of square
L	ℓ	ℓn	ℓs	Ds	K	ℓk

JIS

1 Spiral Fluted Taps (for blind hole)

2 Spiral Fluted Taps (for through hole)

3 Spiral Pointed Taps (for through hole)

4 Hand Taps

5 Cemented Carbide Taps

6 Roll Taps

7 Special Thread Taps (Simple inspection tools)

8 Pipe Taps

9 Thread Mills

10 Dies

11 Center Drills (Centering tools)

JIS

PO LH

Spiral Pointed Taps for Left Hand Threads



Specification



■ The PO LH is a spiral pointed tap for left hand threads in through hole tapping.

Recommended Tapping Speeds depending on Materials

Medium carbon steels 中炭素鋼	High carbon steels 高炭素鋼
5~10 (m/min)	5~10 (m/min)

For icon explanation, refer to icon-1

Segment : 1E

Size	Class	Code	Chamfer	L (mm)	ℓ (mm)	ℓn (mm)	ℓs (mm)	Ds (mm)	K (mm)	ℓk (mm)	No. of flutes	TYPE	MSRP
For Metric Threads													
M3 × 0.5	P2	POQ3.0G-L	5P	46	9	14	26	4	3.2	6	3	1	¥ 1,500*
M4 × 0.7	P2	POQ4.0I-L	5P	52	11	17	29	5	4	7	3	1	¥ 1,500*
M5 × 0.8	P2	POQ5.0K-L	5P	60	13	22	33	5.5	4.5	7	3	1	¥ 1,510*
M6 × 1	P2	POQ6.0M-L	5P	62	15	26	33	6	4.5	7	3	1	¥ 1,670*
M8 × 1.25	P3	POR8.0N-L	5P	70	19	-	36	6.2	5	8	3	2	¥ 2,330*
M8 × 1	P3	POR8.0M-L	5P	70	19	-	36	6.2	5	8	3	2	¥ 2,640*
M10 × 1.5	P3	POR10.0-L	5P	75	23	-	38	7	5.5	8	3	2	¥ 2,970*
M10 × 1.25	P3	POR10.0N-L	5P	75	23	-	38	7	5.5	8	3	2	¥ 2,970*
M10 × 1	P3	POR10.0M-L	5P	75	23	-	38	7	5.5	8	3	2	¥ 3,530*
M12 × 1.75	P4	POS012P-L	5P	82	26	-	42	8.5	6.5	9	3	2	¥ 4,200*
M12 × 1.5	P3	POR0120-L	5P	82	26	-	42	8.5	6.5	9	3	2	¥ 4,200*
M12 × 1.25	P4	POS012N-L	5P	82	26	-	42	8.5	6.5	9	3	2	¥ 4,200*
M12 × 1	P3	POR012M-L	5P	82	26	-	42	8.5	6.5	9	3	2	¥ 4,940*
M14 × 2	P4	POS0140-L	5P	88	26	-	45	10.5	8	11	3	2	¥ 5,740*
M14 × 1.5	P3	POR0140-L	5P	88	26	-	45	10.5	8	11	3	2	¥ 5,740*
M16 × 2	P4	POS0160-L	5P	95	26	-	48	12.5	10	13	3	2	¥ 7,660*
M16 × 1.5	P3	POR0160-L	5P	95	26	-	48	12.5	10	13	3	2	¥ 7,660*
M18 × 2.5	P4	POS018R-L	5P	100	33	-	51	14	11	14	3	2	¥ 10,300*
M18 × 1.5	P4	POS0180-L	5P	100	33	-	51	14	11	14	3	2	¥ 10,300*
M20 × 2.5	P4	POS020R-L	5P	105	33	-	50	15	12	15	3	3	¥ 14,000*
M20 × 1.5	P4	POS0200-L	5P	105	33	-	50	15	12	15	3	3	¥ 14,000*
M20 × 1	P3	POR020M-L	5P	105	18	-	50	15	12	15	3	4	¥ 17,700*
M22 × 2.5	P4	POS022R-L	5P	115	33	-	55	17	13	16	3	3	¥ 17,900*
M22 × 1.5	P4	POS0220-L	5P	115	33	-	55	17	13	16	3	3	¥ 17,900*
M24 × 3	P4	POS024S-L	5P	120	39	-	55	19	15	18	3	3	¥ 22,300*
M24 × 1.5	P4	POS0240-L	5P	120	39	-	55	19	15	18	3	3	¥ 22,300*
M27 × 3	P4	POS027S-L	5P	130	39	-	60	20	15	18	4	3	¥ 31,500*
M27 × 1.5	P4	POS0270-L	5P	130	39	-	60	20	15	18	4	3	¥ 31,500*
M30 × 3.5	P5	POT030T-L	5P	135	46	-	62	23	17	20	4	3	¥ 40,200*
M30 × 1.5	P4	POS0300-L	5P	135	46	-	62	23	17	20	4	3	¥ 40,200*

Overall length	Thread length	Thread + Neck length	Shank length	Shank dia.	Size of square	Length of square
L	ℓ	ℓn	ℓs	Ds	K	ℓk

3

JIS

1 Spiral Fluted Taps (for blind hole)

2 Spiral Fluted Taps (for through hole)

3 Spiral Pointed Taps (for through hole)

4 Hand Taps

5 Cemented Carbide Taps

6 Roll Taps

7 Special Thread Taps (Simple inspection tools)

8 Pipe Taps

9 Thread Mills

10 Dies

11 Center Drills (Centering tools)

TYPE: 1

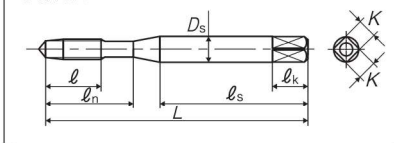

TYPE: 2

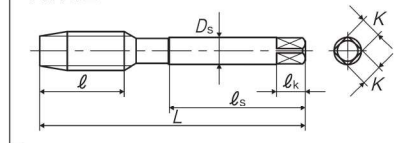

TYPE: 3

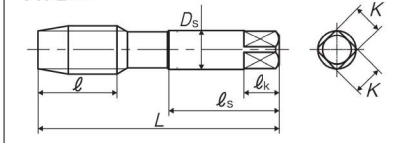

TYPE: 4

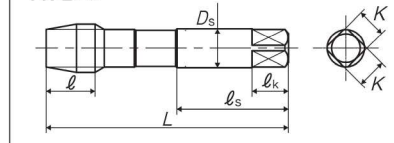

Size	Class	Code	Chamfer	L (mm)	ℓ (mm)	ℓn (mm)	ℓs (mm)	Ds (mm)	K (mm)	ℓk (mm)	No. of flutes	TYPE	MSRP
For Unified Threads													
1/4-20UNC	P2	POQU04N-L	5P	62	15	26	33	6	4.5	7	3	1	¥ 1,900*
1/4-28UNF	P2	POQU04K-L	5P	62	15	26	33	6	4.5	7	3	1	¥ 1,900*
5/16-18UNC	P3	PORU050-L	5P	70	19	-	36	6.2	5	8	3	2	¥ 2,680*
5/16-24UNF	P2	POQU05M-L	5P	70	19	-	36	6.2	5	8	3	2	¥ 2,680*
3/8-16UNC	P3	PORU06P-L	5P	75	23	-	38	7	5.5	8	3	2	¥ 3,440*
3/8-24UNF	P2	POQU06M-L	5P	75	23	-	38	7	5.5	8	3	2	¥ 3,440*
7/16-14UNC	P3	PORU07Q-L	5P	82	26	-	42	8.5	6.5	9	3	2	¥ 4,840*
7/16-20UNF	P3	PORU07N-L	5P	82	26	-	42	8.5	6.5	9	3	2	¥ 4,840*
1/2-13UNC	P3	PORU08R-L	5P	88	26	-	45	10.5	8	11	3	2	¥ 5,140*
1/2-20UNF	P3	PORU08N-L	5P	88	26	-	45	10.5	8	11	3	2	¥ 5,140*
For Whitworth Threads													
1/4W20	P3	PORW04N-L	5P	62	15	26	33	6	4.5	7	3	1	¥ 1,900*
5/16W18	P3	PORW050-L	5P	70	19	-	36	6.2	5	8	3	2	¥ 2,680*
3/8W16	P3	PORW06P-L	5P	75	23	-	38	7	5.5	8	3	2	¥ 3,440*
1/2W12	P3	PORW08S-L	5P	88	26	-	45	10.5	8	11	3	2	¥ 5,140*
5/8W11	P3	PORW10U-L	5P	95	26	-	48	12.5	10	13	3	2	¥ 7,660*
3/4W10	P4	POSW12V-L	5P	105	33	-	50	15	12	15	3	3	¥ 14,000*

JIS

3-43



* = Specified Distribution Items. Made to order products. For improvement, spec may change without advance notice.

* = Specified Distribution Items. Made to order products. For improvement, spec may change without advance notice.



JIS

3-44